



# SPACE STATION



## INTRODUCTION

Designed for rope technicians who use the TerrAdaptor to push the boundaries of what is possible with artificial high directionals, the Space Station adds even more capability to the world's most versatile industrial tripod.

## SPACE STATION KIT

1. FREE MODULE
2. ROPE HORN
3. FREE RIGGING PLATE
4. FIXED MODULE
5. FIXED RIGGING PLATE
6. LEG COUPLING PIN
7. 5 1/2" MAIN ATTACHMENT PIN
8. BAG (NOT PICTURED)

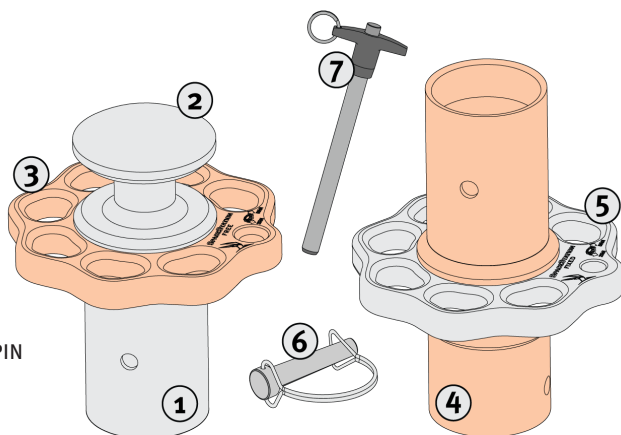

## BEFORE USE

The techniques employed in the proper and safe use of this equipment may only be learned through PERSONAL instruction received from an instructor who is well-qualified in all phases of vertical rope work. Such instruction will include an evaluation of your comprehension of, and ability to perform, the tasks required to safely and efficiently use this equipment. Never attempt use until you have received such instruction and are believed competent by your instructor.

## INSPECTION FOR USE

Visually and by touch, inspect the Space Station for cracks, distortion, corrosion, scratches or gouges, sharp edges or rough areas that might abrade a rope. Inspect attachment points and attachment pin holes for wear. Distorted attachment points or pin holes may indicate that this unit has been overloaded. Inspect pins for proper function. Ensure that the fixed rigging plate does not rotate and that the free rigging plate does rotate. Compare this Space Station with a new model if necessary, to determine its condition. Remove it from service if there is any doubt about its safety or serviceability. See MAINTENANCE and REMOVAL FROM SERVICE notes in these instructions for further information on servicing the Space Station.

## INSTRUCTIONS FOR USE

The Space Station is comprised of a Fixed Module and a Free Module. The Modules can be used in a coupled configuration or individually, as needed. The Free Module has a rotating rigging plate that will self-align with the load or when using guy lines. The Fixed Module has a rigging plate that will not rotate freely, which can be useful in situations when a connection in a specific position is needed.

The modules are color-coded to indicate which TerrAdaptor tubes they are compatible with: the Free module has a gray tube which can be connected to orange Mid-tubes [Fig. 1] and the Fixed module has an orange tube which can be connected to a gray Perf-tube [Fig. 2].

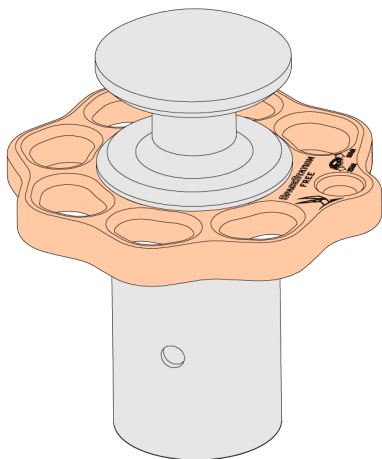

FIG. 1 : FREE MODULE

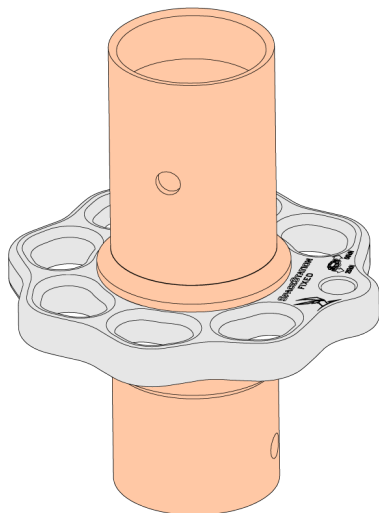

FIG. 2: FIXED MODULE

### Coupled Configuration:

Both modules can be combined to create a double decker head for a monopod or davit arm configuration. This configuration allows for rigging guy-lines/tie-backs to the Free Module and rigging loads from the Fixed Module. Rigging the load below the guy-lines creates a more stable system and minimizes the possibility of capsizing the system in shock-loading or dynamic events.

The rope horn and rigging plate have been designed to reduce the number of carabiners needed by looping a bight of webbing, cord or rope through the rigging plate and over the horn [Fig. 3].

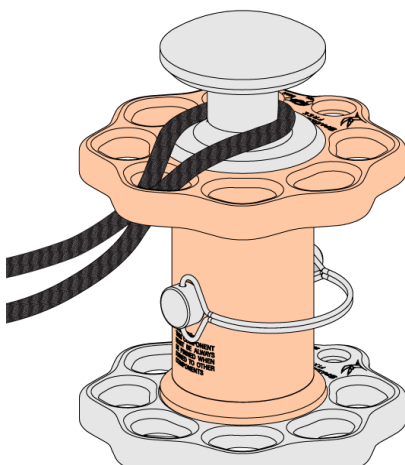

FIG. 3: ROPE BIGHT OVER HORN

**Coupled Configuration (cont'd):**

The Free Module rigging plate has been designed to rotate and center itself between the guy lines and rigging lines to prevent any torque from being imparted to the leg tubes.

The fully coupled Space Station fits on the end of a gray TerrAdaptor Perf-tube [Fig. 4]. Use one leg coupling pin to connect the two modules to each other and attach the Space Station to the end of the gray Perf-tube with a second leg coupling pin.

Ensure that the gray tube on the Free Module is COMPLETELY inserted into the correct end of the orange tube [Fig. 5A] on the Fixed Module and that NO WARNING TEXT FROM THE GRAY TUBE IS SHOWING [Fig. 5B].

The logos on the rigging plates should always be visible together when the two Modules of the are coupled [Fig. 6]. The Free Rigging Plate may rotate to balance the load when in operation.

**NOTE:** The included 5½” attachment pin should NOT be used to join the rigging plates when using the coupled configuration in a monopod application.

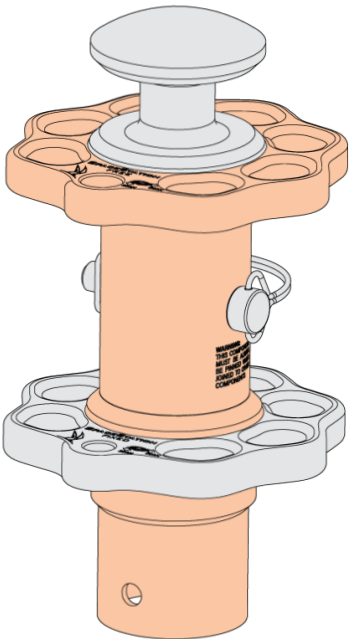

FIG. 4: COMPLETE COUPLING CONFIGURATION

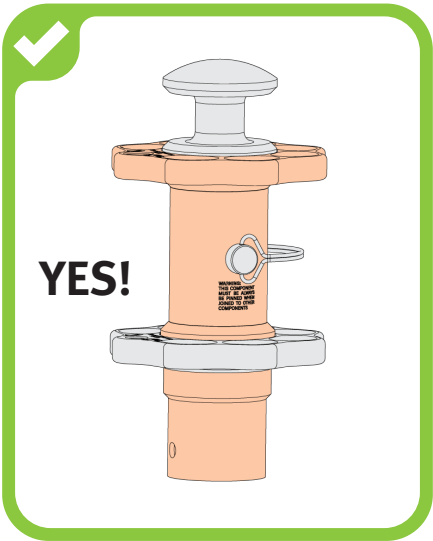

FIG. 5A: CORRECT CONFIGURATION OF MODULES

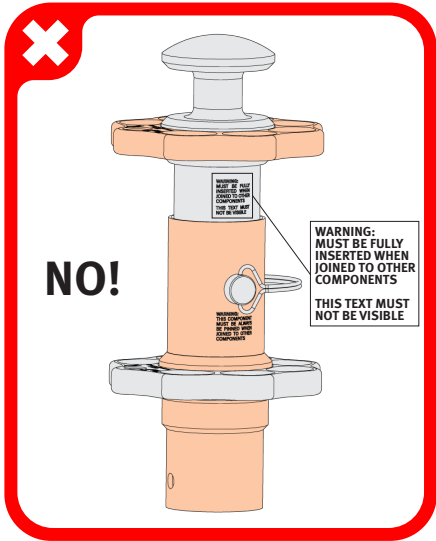

FIG. 5B: INCORRECT CONFIGURATION OF MODULES

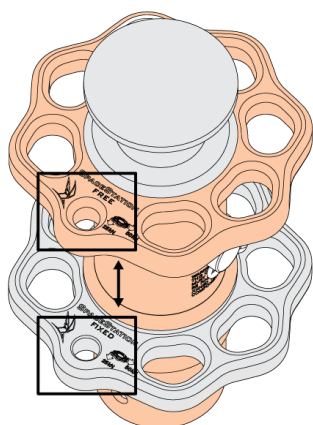
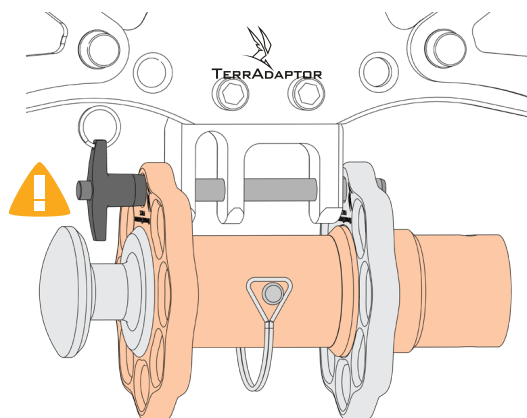

FIG. 6



**ENSURE MAIN ATTACHMENT PIN IS FULLY ENGAGED  
IN TERRADAPTOR YOKE BEFORE USE!**

FIG. 7: ATTACHMENT TO TERRADAPTOR HEAD

## Using with the TerrAdaptor: Coupled Configuration

Using the Coupled Configuration, both modules can add 14 connection points to the head of the TerrAdaptor. After connecting both modules together and securing with leg pin, attach the Space Station to the yoke on the head of the TerrAdaptor using the included 5½" long main attachment pin [Fig. 7]. The rope horn can be used in this configuration.

**WARNING: DO NOT USE THE 4½" MAIN ATTACHMENT PIN THAT IS PROVIDED WITH THE TERRADAPTOR, AS IT IS TOO SHORT TO CREATE A SECURE CONNECTION!**

Before loading, ensure that no gray tube from the Free Module is visible [Fig. 5A] and that the logos on each rigging plate are visible together [Fig. 6].

## Using with the TerrAdaptor: Individual Use

Each module can be used separately with the TerrAdaptor in several configurations.

**Free Module [Fig. 1]:** Can be attached to the end of an orange Mid-tube to create a head for a monopod or davit arm. The rope horn can be used for direct connections of rigging/guy lines at the head of a monopod [Fig. 3]. The rope horn can also be placed on the bottom of the tube to create a foot with attachment points.

**Fixed Module [Fig.2]:** Can be attached anywhere along a gray Perf-tube [Fig. 8]. Position it on the middle of the tube to create multiple additional anchor points mid-span, or attach it near the end of the tube as a head for a monopod or davit arm.

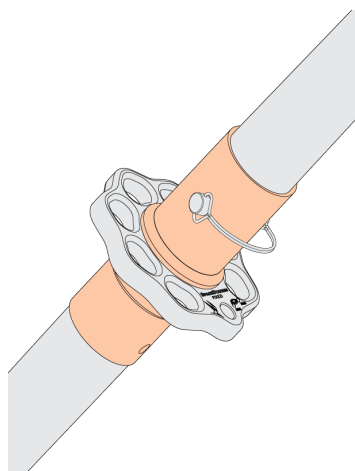

FIG. 8: ATTACHMENT TO GREY PERF TUBE

**WARNING: DO NOT USE SPACE STATION TO JOIN TWO GREY PERF-TUBES TOGETHER.**

## WARNING

YOU COULD BE KILLED OR SERIOUSLY INJURED IF YOU DO NOT READ AND UNDERSTAND THE USER INSTRUCTION BEFORE USING THIS PIECE OF EQUIPMENT. SPECIAL TRAINING AND KNOWLEDGE ARE REQUIRED TO USE THIS EQUIPMENT. YOU MUST THOROUGHLY READ AND UNDERSTAND ALL MANUFACTURER'S INSTRUCTIONS BEFORE USE. USE AND INSPECT THIS EQUIPMENT ONLY IN ACCORDANCE WITH THESE INSTRUCTIONS. RIGGING ARTIFICIAL HIGH DIRECTIONALS REQUIRES ADVANCED TRAINING AND EXPERIENCE. USERS MUST UNDERSTAND THAT SYSTEM STRENGTH OF ANY ARTIFICIAL HIGH DIRECTIONAL ANCHOR MAY BE LOWER THAN THE STATED STRENGTH OF ANY COMPONENT IN THE SYSTEM, INCLUDING THE SPACE STATION.

## MAINTENANCE

Carefully clean with water and a mild detergent. Dry with soft cloth and remove all dirt, foreign material, and moisture. Minor sharp edges may be smoothed with a fine abrasive cloth before cleaning. No lubrication is required. Store in provided bags in a clean and dry area.

## RECORDS

It is suggested that the user of this Space Station keep a permanent record listing the date and results of each usage and inspection. Such record should show, at a minimum, inspection for all the following conditions:

- Cleanliness
- Dryness
- Freedom from scratches, cracks, gouges, sharp edges, or deep wear
- Freedom from corrosion
- Freedom from distortion
- Free Module rigging plate rotates easily and smoothly
- Pins in proper working order
- User Information sheet present

## USE OF THIS USER INFORMATION SHEET

It is suggested that this User Instruction sheet be retained in a permanent record after it is separated from the Space Station, and that a copy of it be kept with the equipment. It is suggested that the user refer to this User Instruction sheet before and after each use of the Equipment. Replacement user instructions can be found online at <https://smcgear.com/terradaptor-user-instructions.html>, or by contacting [customerservice@smcgear.com](mailto:customerservice@smcgear.com)

## REMOVAL FROM SERVICE

The Space Station should be removed from service and inspected thoroughly in the following conditions:

- Dropped from sufficient height
- Exposed to sufficient heat to alter its surface appearance
- Bending, warping, distortion of any part
- Cracks on any surface
- Scratches/gouges of more than a superficial nature
- The Fixed Module [Fig. 1] rigging plate [grey] spins or moves
- The Free Module [Fig. 2] rigging plate [orange] does NOT rotate easily
- The rope horn spins or moves freely from the rigging plate

After inspection and assessment, please follow warranty procedures for further determination on servicing the Space Station.

WARRANTY

Standard SMC warranty policy applies to the Space Station and its component parts:

LIMITED WARRANTY: SMC products are warranted to the original purchaser in accordance with the full Statement of Limited Warranty printed on our web site, [www.smcgear.com/warranty](http://www.smcgear.com/warranty). Service under this warranty is available by contacting us by mail, email or phone. All items that are claimed to be defective must be returned under a pre-assigned CC Number and should include a detailed description of the conditions existing during use of the item as well as the place and date of the original purchase and a copy of the original invoice or receipt. Include contact information.

Due to the complexity of the Space Station, if one of the main components of the system appears to be damaged, the entire system is suspect to failure and must be inspected by the manufacturer. As a result, replacement parts for these components are not available without first sending them to SMC for inspection.

If during inspection the parts are determined to be damaged as a result of a manufacturer defect, the necessary part(s) will be replaced at no cost to the end user. If the manufacturer determines that the damage is due to misuse, overloading, unsafe configurations or neglect, the replacement part(s) may be made available to the user at user’s expense. Any parts deemed unsafe will not be returned to the user.

Warranty Registration Information

Name:
Address:
Phone:
Email:
Purchase Date:
Purchased From:
Manufacturer Lot Number (MLN):

See below for an Inspection and Maintenance Log Example.

Item	Qty	Date	Inspected By	Findings	Safe for Use
Free Module					
Fixed Module					
5 1/2” Main Attachment Pin					
Leg Coupling Pin					

**Manufactured by:**



**SMC - Seattle Manufacturing Corporation**  
6930 Salashan Parkway | Ferndale, WA 98248 | USA  
Phone: 360.366.5534  
Email: [customerservice@smcgear.com](mailto:customerservice@smcgear.com)  
[www.smcgear.com](http://www.smcgear.com)

**Distributed by:**



**PMI - Pigeon Mountain Industries**  
4466 N US Hwy 27 | Lafayette, GA  
30728 | USA  
Phone: 706.764.1437  
[www.pmirope.com](http://www.pmirope.com)



**Skedco, Inc.**  
10505 SW Manhasset Drive | Tualatin, OR  
97062 | USA  
Phone: 503.691.7909  
[www.skedco.com](http://www.skedco.com)